

Powerful, Mid-Range Line Printer

T6065



Best price/performance in mid-range line printer

The T6065 is designed to produce time sensitive, large volume critical business documents at very low cost. Critical applications such as high quality multi-part printing on invoices, reports, special labels, or bar coded media are ideal tasks for this product.

Superior print quality is achieved by a special impact element that creates a uniform, solid dot image. Font styles, character sizes and print attributes can be mixed on a single line, and Tally's exclusive Read/Right bar code algorithm creates sharp bar codes with no loss of throughput.

Excellent Features

- 650 lines per minute; unlimited duty cycle
- Mission critical durability
- Available in Tabletop and Enclosed Pedestal versions

Outstanding Forms Handling

- Straight paper path; up to 6-part forms
- 4-tractor system
- Paper motion and paper out detection

Consistent Print Quality

- Quick-change, clean-hands, long-life ribbon cartridges
- Stored-energy hammer bank technology

Exceptional Connectivity

- Twinax, Coax, Ethernet, IPDS and IPDS over TCP/IP

Superior Compatibility

- Wide range of standard emulations for legacy systems/PC/LAN compatible
- QMS® Code V™ and Printronix® Graphics Language (PGL) compatibility for industrial graphics and bar codes

Monochrome Laser
Line Matrix **Computer Printers**
Color Laser Ink Jet
Serial Dot Matrix

Tally®
Computer Printers

Powerful, Mid-Range Line Printer

Features & Specifications	T6065
Print Technology	Line impact dot matrix
Print Speed	Text: 650 lines per minute, draft: 488 lines per minute, data processing: graphics: 73 inches per minute
Workload	185,000 pages per month
Acoustic Level	52 dB(A); Enclosed Pedestal
Character Printing Modes	Constant density fonts; enhanced fonts
Character Sets	52 language sets
Characters Per Inch	5, 6, 6.7, 7.5, 8.3, 8.6, 10, 12, 13.3, 15, 16.7, 17.1, 20 cpi
Lines Per Inch	1.5, 2, 3, 4, 5, 6, 8, 9, 10 & 12 (plus variable line spacing)
Fonts	Draft, Data processing, Courier, Gothic, OCR A & B
Character Styles	Bold, italic, superscript, subscript, underline, overline, and strikethrough
Graphics Resolution	Maximum: 240 x 288 (H x V)
Graphics Compatibility	Tally Industrial Graphics; QMS® CODE V™ Version 2; Printronix® PGL
Bar Codes	Code 39, Code 128, Interleaved 2 of 5, UPC-A, UPC-E, EAN 8, EAN 13, EAN 128, Codabar, Identicon 2 of 5, MSI, POSTNET
Control Panel	Alphanumeric display (six languages) provides complete access to printer operation, configuration, calibration and test features. Includes lockout feature.
Paper Handling	Straight paper path, four tractor system, quick access feature - easy access to forms and labels, paper out and paper motion detection, forms position retained in non-volatile memory.
Print Media	Up to 6-part forms, forms thickness maximum .025", weight: 15-100 lb. stock
Paper Sizes	Width: 2.5" – 17.25", forms length: 1 – 255 lines
Paper Advance	Slew Speed: 16 inches per second (max.)
Standard Interface	Serial RS-232 (up to 38.4K Baud) and IEEE-1284 Compliant Centronics Parallel (both parts hot, and active port selected automatically)
Standard Emulations	Tally Line Printer, Printronix® P600 and P6000, HP 2564C, DEC® LG01, Epson® FX1180, Genicom® ANSI & IBM® Proprinter III XL
Ribbon	Easy-load, clean-hands cartridges, 25, 50 & 150 million characters
Physical (H x W x D)	Tabletop: 15.8" x 31.5" x 23.2", 90 lbs.; Tabletop on Stand: 41.4" x 31.5" x 23.7", 120 lbs. Enclosed Cabinet: 40.6" x 31.5" x 23.2", 142 lbs.
Power Requirements	90 - 130/180 - 264 V, 57 - 63/47 - 53 Hz (auto-ranging)
Environmental	Temperature range: 10°C to 40°C (operating); -20°C to 60°C (non-operating) Humidity: 10% to 90% non-condensing (operating); 5% to 95% non-condensing (non-operating)
Optional Interfaces	FourPlex I/O: Twinax, Coax, Serial and Parallel, IPDS for FourPlex LANPlex I/O: Ethernet (10BaseT/100BaseT), Serial and Parallel, IPDS for LANPlex Extended Parallel I/O: Dataproducts Standard, Dataproducts Long Lines; Serial and Parallel. FourPlex and LANPlex also available as factory configured models

Tally Printer Outlet

1-866-430-6202

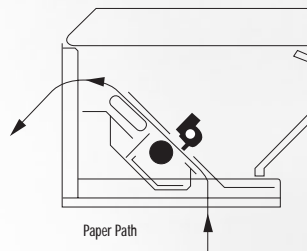

Tally®
Computer Printers



T6065 Enclosed Pedestal



T6065 with Pedestal



BSEN ISO 9001: 1994
Certificate No. FM 28149



Tally Printer Outlet.Com
1-866-430-6202

Fax for a Quick Quote
817-430-6250

Choose Model:

T6065

Organization _____

Name _____

Phone (_____) _____ Fax Number (_____) _____

E-Mail _____

Address _____

City _____ State _____ Zip _____

Please indicate your specifications or requirements:

Additional Comments:
